

Default Qty.	PART NUMBER
1	01-52-00-1-01-BOILER SHELL
2	01-52-00-1-02-HORIZONTAL LONG STAY
7	01-52-00-1-03-HORIZONTAL CROSS STAY
24	01-52-00-1-04-VERTICAL STAY
94	01-52-00-1-05-HORIZONTAL SHORT STAY TYPE-1
14	01-52-00-1-06-HORIZONTAL SHORT STAY TYPE-2
1	01-52-00-1-07-STIFFENING RING
1	01-52-00-1-08-DOME MOUNTING RING
2	01-52-00-1-09-NIPPLE FOR W.L.G.
1	01-52-00-1-10-NIPPLE FOR REGULATOR HANDLE

MATERIAL ABBREVIATIONS:
 ALU = ALUMINIUM
 HALU= HARD ALUMINIUM
 BRS = BRASS
 BRZ = BRONZE OR GUNMETAL (BRZ/GM)
 CI = CAST IRON
 CU = COPPER
 GRA = GRAPHITE
 MS = MILD STEEL/BRIGHT MILD STEEL
 SS = SILVER STEEL OR STAINLESS STEEL
 SPS = SPRING STEEL
 PEEK= POLYETHER ETHER KETONE
 SYN = SYNTHETIC MATERIAL SUCH AS VETON, NYLON, TEFLON OR RUBBER

IN GENERAL SYNTHETIC MATERIALS SOULD BE ABLE TO WITHSTAND THE HEAT AND PRESSURE(S) APPLIED TO THEM.
 nnn/nnn MEANS THAT EITHER MATERIAL CAN BE USED

OTHER ABBREVIATIONS
 AS = AS SHOWN
 DP = DEEP
 DAA= DRILL AFTER ASSEMBLY
 D&TAA= DRILL AND TAP AFTER ASSEMBLY
 CF = CLOSE FIT (SIZE FOR SIZE)
 PF = PRESS FIT
 PFAA= PRESS FIT AFTER ASSEMBLY
 PCD = PITCH CIRCLE DIAMETER
 RM = REAM
 HEX = HEXACON, 6SIDED
 CP = COMPRESSED
 KNL = KNURLED
 CSK = COUNTERSINK
 PL = PLACES
 DWL= DOWEL
 SPF= SPOTFACE
 (T)HESOP=(TAPPED)HOLES EQUALLY SPACED ON PCD
 (T)HESOC=(TAPPED)HOLES EQUALLY SPACED ON CIRCUMFERENCE
 OD = OUTSIDE DIAMETER
 ID = INSIDE DIAMETER
 MAX/MIN = CRITICAL DIMENSION
 SA-xxx = SUB ASSEMBLY-xxx

IMPORTANT NOTE:
 BEFORE STARTING: IT IS STRONGLY ADVISED THAT THE BOILER AS SHOWN ON THESE DRAWINGS SHOULD BE INSPECTED BY AN AUTHORISED PROFESSIONAL ENGINEER AND THE WORKING AND MAXIMUM BOILER PRESSURE TO BE CALCULATED.
 MAKE SURE THE BOILER FULLY COMPLIES WITH THE LOCAL RULES AND REGULATIONS OF MODEL BOILERS.
 A COMPLIANCE AND SAFETY/TEST CERTIFICATE SHOULD BE OBTAINED.

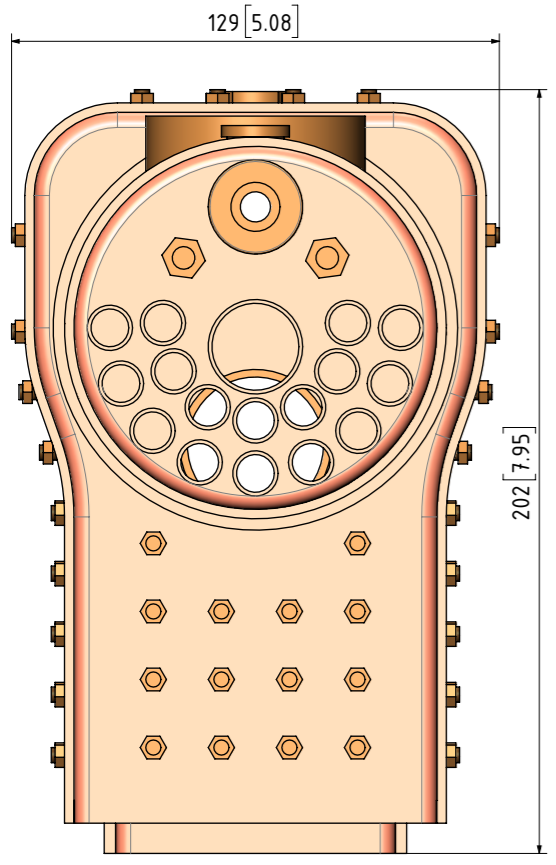
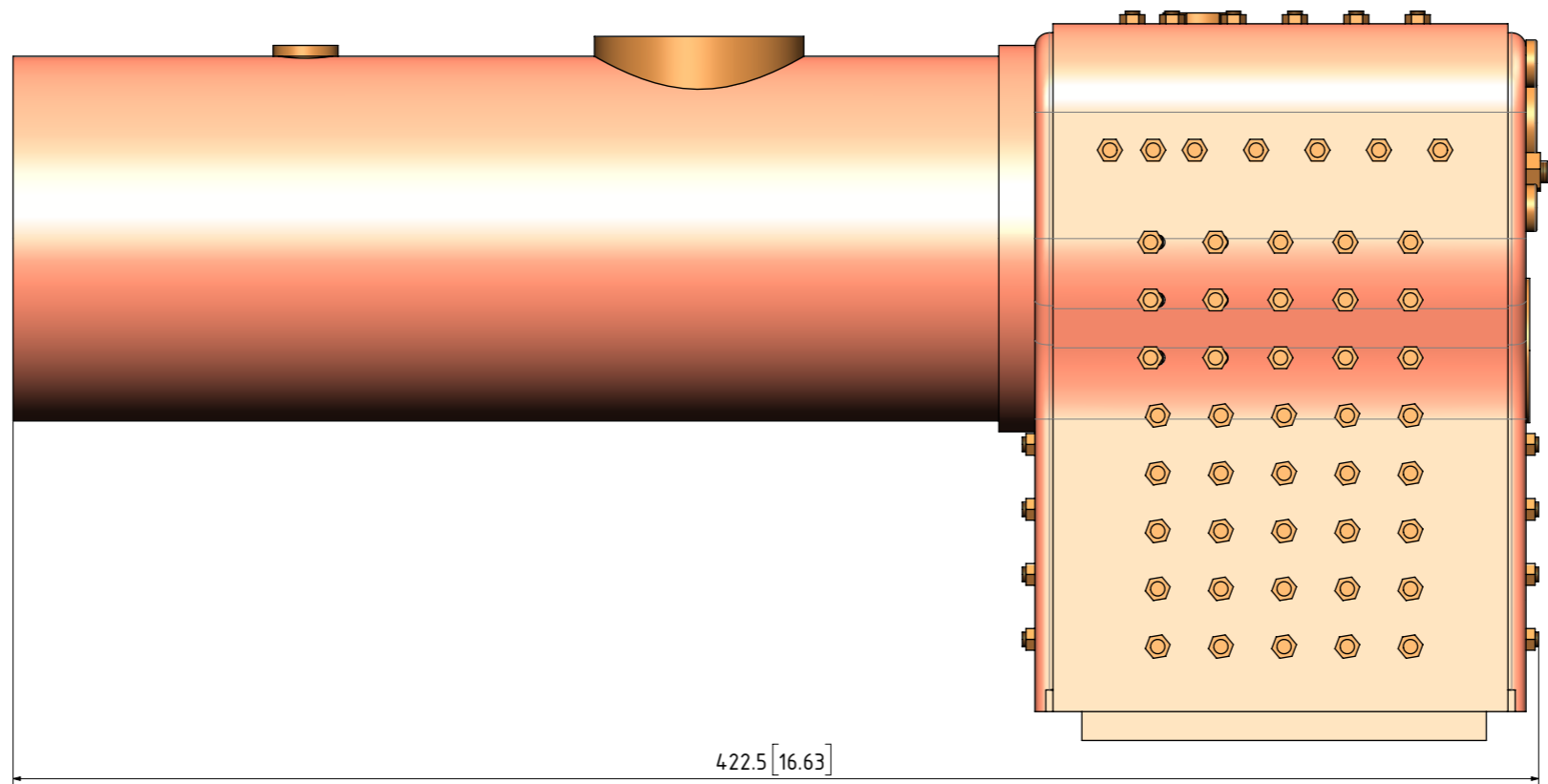
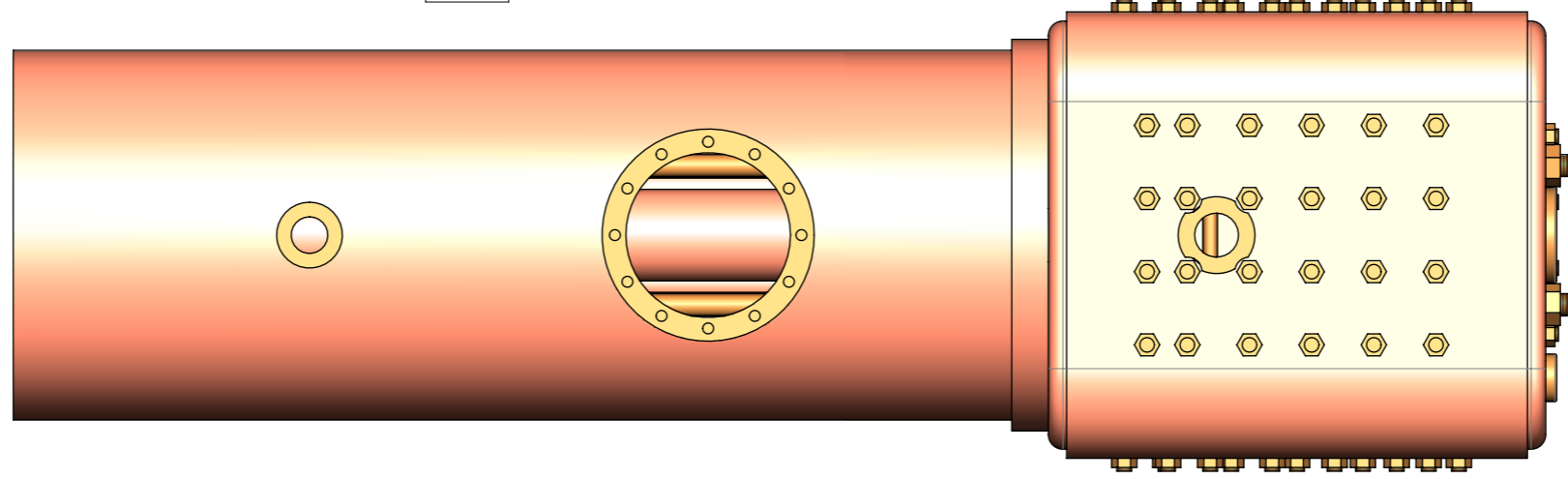
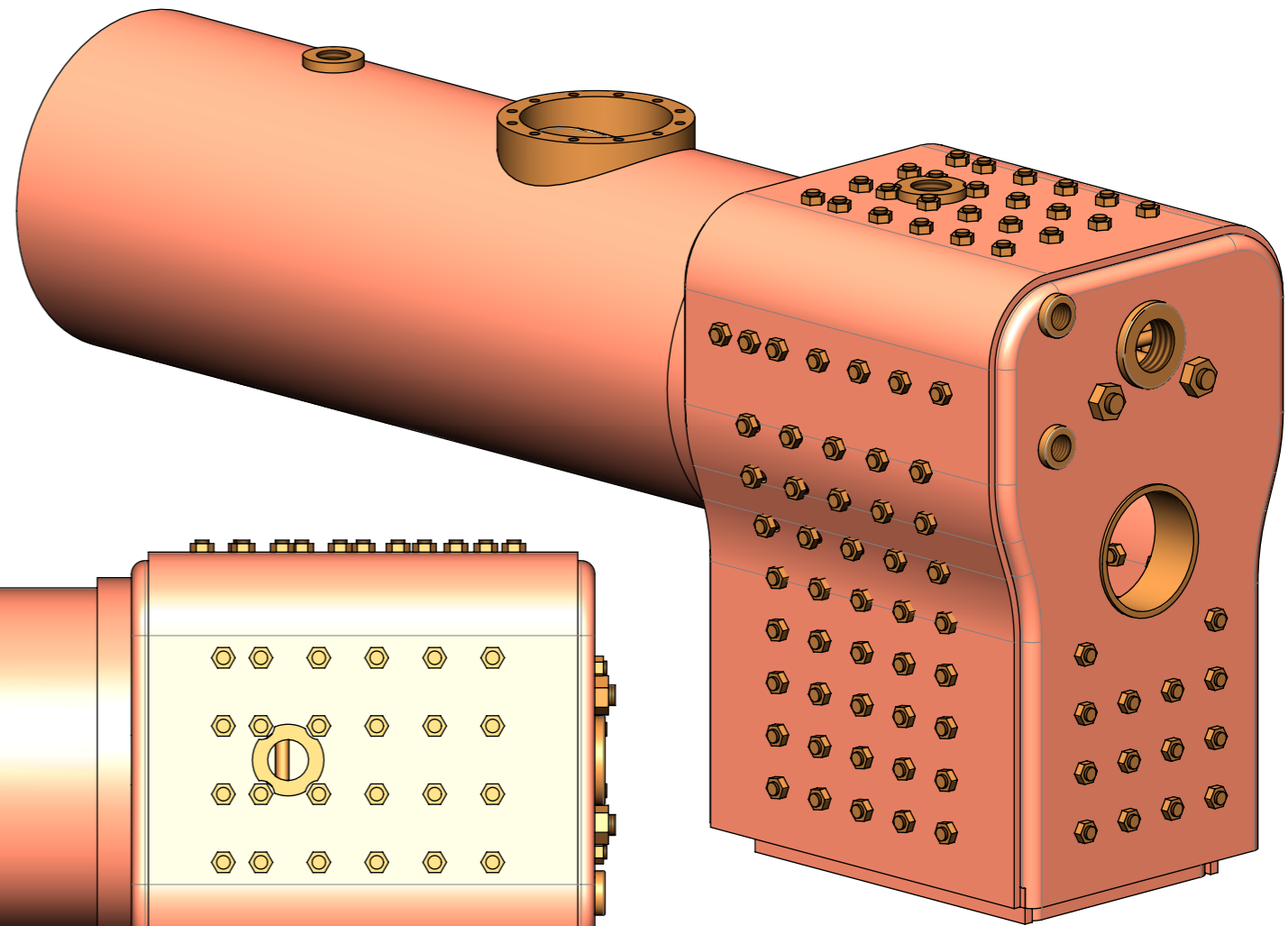

422.5 [16.63]

NOTES: FOUND HE ORIGINAL DRAWING(S) ON THE INTERNET AND WERE SIGNED BY C.J.STROETINGO? DATED JUNE 1996

TITLE
**A BOILER FOR A GWR 0-4-2 14XX CLASS
 5inch LOCOMOTIVE**

DRAWING CONTENTS
**GENERAL ARRANGEMENT, VIEWS,
 NOTES**

PROJECT No 01-52-00
 JDW DRAUGHTING SERVICES
 J.A.M. DE WAAL, 12 BRIGHTWELL STREET PAPAOKURA
 2110, NEW ZEALAND. PHONE: 0064 09 2988815. MOB:
 0211791000 E-MAIL: dewaal@xtra.co.nz.

PROJECTION
JDWDS
 DATE JANUARY 2023
 SHEET: 01 OF 04

MODEL SCALE: 1:1
 DWG SCALE: 1:1 @A3 OR AS SHOWN
 Copyright © J.A.M. DE WAAL PAPAOKURA NZ
A3 No: 01-52-00-SHT-01

DRAWINGS ARE FOR PERSONAL USE ONLY NOT FOR COMMERCIAL PURPOSES