

QTY.	PART NUMBER	SUGGESTED MATERIALS
1	SS-01-WOOD BASE	WOOD
2	SS-02-FLYWHEEL STAND	PAINTED STEEL
2	SS-03-FLYWHEEL BEARING	BRONZE
1	SS-04-FLYWHEEL	PAINTED STEEL
1	SS-05-CRANK SHAFT	STEEL
1	SS-06-CRANK	STEEL OR BRASS
1	SS-07-CRANK PIN	SILVER STEEL
1	SS-13-BALANCE ARM STAND	STEEL OR BRASS
1	SS-14-STEEL BASE PLATE	PAINTED STEEL
2	SS-15-CYLINDER	STEEL OR BRASS
2	SS-16-CYLINDER TOP COVER	STEEL OR BRASS
2	SS-17-CYLINDER BOTTOM COVER	STEEL OR BRASS
2	SS-18-PISTON ROD GLAND	BRASS
2	SS-19-PISTON ROD GLAND NUT	BRASS
1	SS-21-BALANCE ARM	STEEL OR BRASS
2	SS-22-PISTON	BRASS
2	SS-24 PISTON ROD	SILVER STEEL
1	SS-25-PIVOT AXLE	SILVER STEEL
1	SS-27-EXCENTRIC HOUSING	STEEL OR BRASS
1	SS-28-EXCENTRIC	STEEL OR BRASS
1	SS-29-VALVE CHAMBER	STEEL OR BRASS
1	SS-30-VALVE CHAMBER TOP COVER	STEEL OR BRASS
1	SS-31-VALVE CHAMBER BOTTOM COVER	STEEL OR BRASS
1	SS-32-VALVE ROD GLAND	BRASS
1	SS-33-VALVE ROD GLAND NUT	BRASS
1	SS-34-VALVE	STEEL OR BRASS
1	SS-35-STEAM INLET PIPE	COPPER
4	SS-36-STEAM INLET-OUTLET NIPPLE	BRASS
1	SS-37-STEAM INLET-OUTLET PIPE TOP	COPPER
1	SS-38-STEAM INLET-OUTLET PIPE BOTTOM	COPPER
1	SS-39-STEAM INLET-OUTLET PIPE BOTTOM	COPPER
1	SS-40-STEAM INLET-OUTLET PIPE TOP	COPPER
4	SS-41-BASE PLATE STAND OFF	SILVER STEEL
1	SS-42-CRANK SHAFT LOCKING PIN	STEEL
1	SS-43-FLYWHEEL SHAFT LOCKING PIN	STEEL
2	SS-44-PISTON ROD SEAL	TEFLON/NYLON
1	SS-45-VALVE ROD SEAL	TEFLON/NYLON
2	SS-46-PISTON RING	TEFLON/NYLON
9	SS-M3 NUT	STEEL OR BRASS
4	SS-M3 THREADED ROD	STEEL OR BRASS
1	SS-M3x8	STEEL OR BRASS
10	SS-M4 NUT	STEEL OR BRASS
6	SS-M4x10	STEEL OR BRASS
2	SS-M5 HALF NUT	STEEL OR BRASS
16	SS-M5 NUT	STEEL OR BRASS
8	SS-M5 THREADED ROD	STEEL OR BRASS
7	SS-M6 HALF NUT	STEEL OR BRASS
4	SS-WOOD SCREW	STEEL OR BRASS
2	SS-M2.5 GRUB SCREW	STEEL OR BRASS

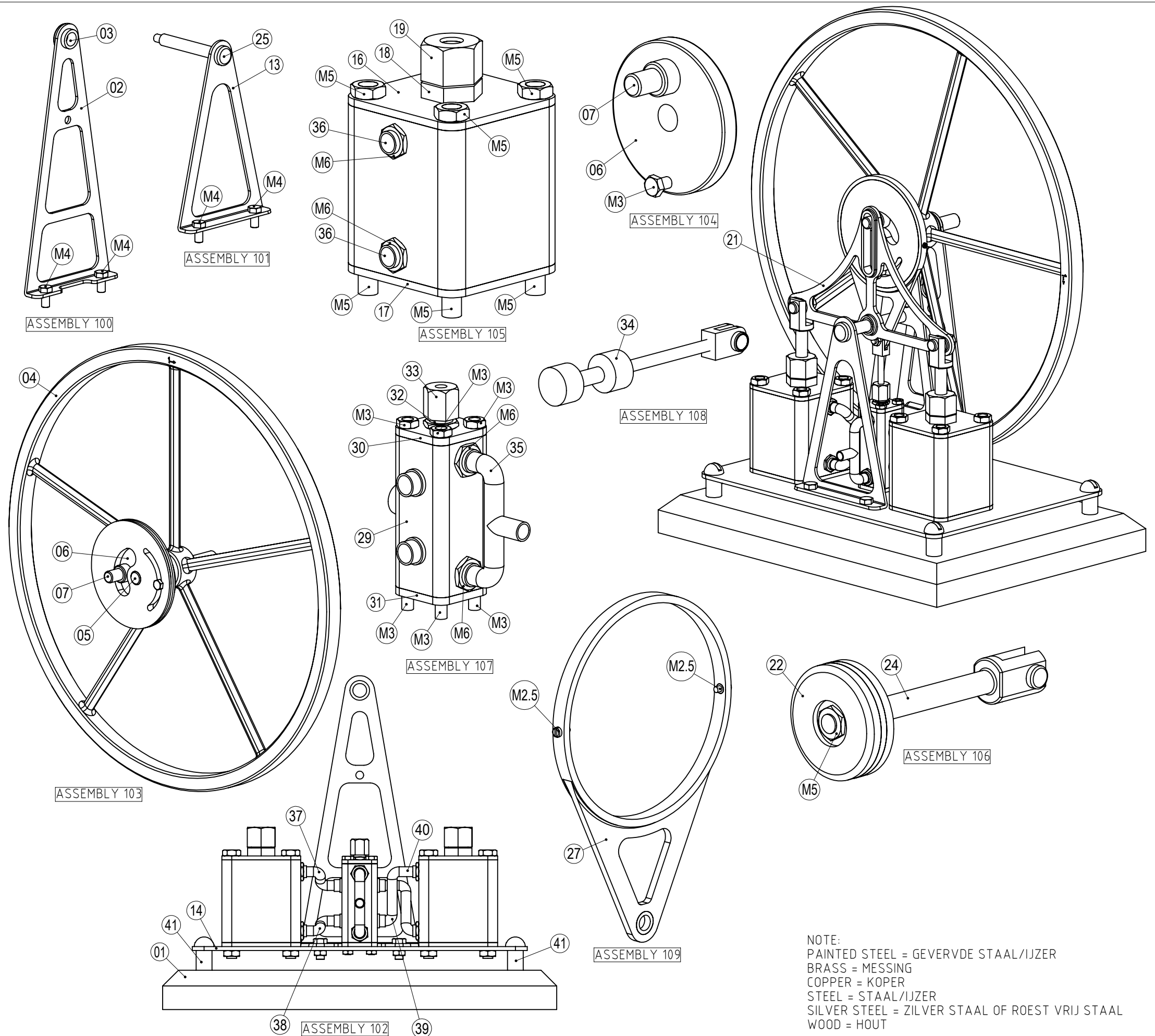

NOTE:  
 PAINTED STEEL = GEVERVDE STAAL/IJZER  
 BRASS = MESSING  
 COPPER = KOPER  
 STEEL = STAAL/IJZER  
 SILVER STEEL = ZILVER STAAL OF ROEST VRIJ STAAL  
 WOOD = HOUT

A3 TITLE  
 EXPERIMENTAL VERTICAL TWO CYLINDER SEE-SAW STEAM ENGINE.  
 ASSEMBLIES

ISSUED TO NVM	DATE	JDW DRAUGHTING SERVICES 12 BRIGHTWELL STREET PAKAPURA NEW ZEALAND TEL/FAX 0064-09-2988815 E-MAIL:dewaal@xtra.co.nz	DRAWN BY J.A.M. DE WAAL	PROJECTION 	DRAWING NUMBER SS-001	SHEET
REV	DESCRIPTION		DATE MAY 2009	SCALE 1:1 or AS SHOWN	CAD FILE	REV A